

ROUND TUBE IRON HANGER SPECIFICATIONS

DJ5

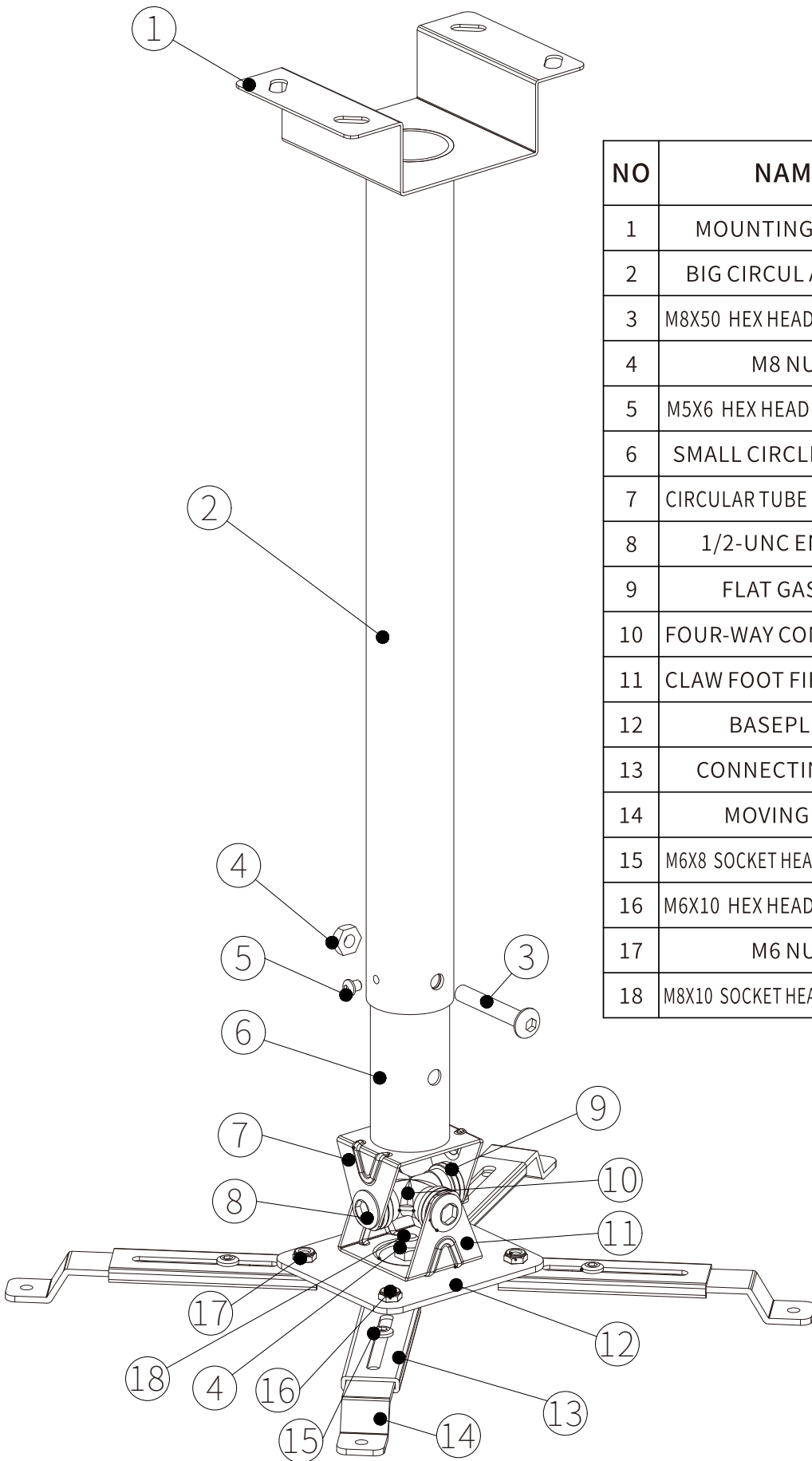

NO	NAME	TEXTURE	NUMBER
1	MOUNTING PLATE	1.5mm SGCC	1
2	BIG CIRCULAR TUBE	carbon steel tubing Thickness:1mm	1
3	M8X50 HEX HEAD CAP SCREW	Nickel plating	1+2N
4	M8 NUT	Nickel plating	1+2N
5	M5X6 HEX HEAD CAP SCREW	Nickel plating	1
6	SMALL CIRCLLAR TUBE	carbon steel tubing Thickness:1mm	1
7	CIRCULAR TUBE BASEBOARD	1.5mm SGCC	1
8	1/2-UNC END CAP	1/2"X15	4
9	FLAT GASKET	Q195 D22X3XD14	8
10	FOUR-WAY CONNECTION	304 1/4-150	1
11	CLAW FOOT FIRED PLATE	1.5mm SGCC	1
12	BASEPL ATE	Q235A	1
13	CONNECTING ARM	Q235A	4
14	MOVING ARM	Q235A	4
15	M6X8 SOCKET HEAD CAP SCREW	Nickel plating	4
16	M6X10 HEX HEAD CAP SCREW	Nickel plating	4
17	M6 NUT	Nickel plating	4
18	M8X10 SOCKET HEAD CAP SCREW	Nickel plating	1

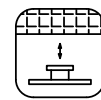

WALL DISTANCE
41-65cm 60-100cm
60-149cm 115-198cm

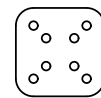

HOLE SITE
Max 420mm



TATED LOAD
30Kg/66lbs